

F30MF



FLAT SUCTION CUP WITH CLEATS, MARK FREE

- ▶ Suction cup of TPU, a mark free material that leaves no trace on the object being handled.
- ▶ Suitable for flat surfaces.
- ▶ Good stability and little inherent movement.
- ▶ Recommended when the lifting force is parallel to the surface of the object.

LIFTING FORCES & TECHNICAL DATA

| Lifting force vertical to the surface, N, at vacuum level | | | Lifting force parallel to the surface, N, at vacuum level | | | Volume cm ³ | Min. curve radius mm | Max. vertical movement mm | Weight rubber part g |
|---|---------|---------|---|---------|---------|---------------------------|-------------------------|------------------------------|-------------------------|
| 20 -kPa | 60 -kPa | 90 -kPa | 20 -kPa | 60 -kPa | 90 -kPa | | | | |
| 11.0 | 34.5 | 48 | 13,6 | 28 | 42 | 2.0 | 44 | 1.5 | 2.2 |

MATERIAL SPECIFICATIONS

| Material | Colour | Hardness °Shore A | Temperature range °C |
|---------------------------------|-------------------|----------------------|-------------------------|
| Thermoelastic polyurethane, TPU | Transparent white | 81 | -20-80 |

MATERIAL RESISTANCE

| Wear resistance | Oil | Weather & Ozone | Hydrolysis | Petrol | Concentrated acids | Alcohol | Oxidation |
|-----------------|-----------|-----------------|------------|--------|--------------------|---------|-----------|
| Excellent | Excellent | Excellent | Poor | Poor | Poor | Good | Good |

ORDERING INFORMATION

| Complete suction cups | | Art. No. |
|-----------------------|--|----------|
| A | Suction cup F30MF Thermoelastic polyurethane, M5 female | 0101357 |
| A | Suction cup F30MF Thermoelastic polyurethane, M5 female, with dual flow control valve | 0101363 |
| B | Suction cup F30MF Thermoelastic polyurethane, G1/8" male, with mesh filter | 0101358 |
| B | Suction cup F30MF Thermoelastic polyurethane, G1/8" male, with mesh filter and dual flow control valve | 0101364 |
| C | Suction cup F30MF Thermoelastic polyurethane, G1/8" male/M5 female, with mesh filter | 0101362 |
| D | Suction cup F30MF Thermoelastic polyurethane, 5xM5 female | 0101361 |
| D | Suction cup F30MF Thermoelastic polyurethane, 5xM5 female, with dual flow control valve | 0101367 |

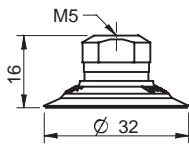

A

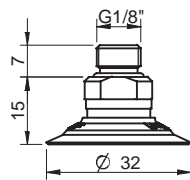

B

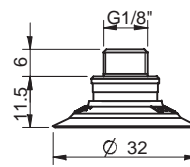

C

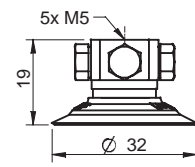

D

| Rubber parts | | Art. No. |
|--|--|----------|
| Suction cup F30MF Thermoelastic polyurethane | | 0101141 |

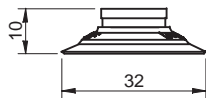

| Fittings | | Art. No. |
|--|--|----------|
| Fitting M5 female | | 3250003 |
| Fitting M5 female, with dual flow control valve | | 3251001 |
| Fitting G1/8" male, with mesh filter | | 3250085 |
| Fitting G1/8" male, with mesh filter and dual flow control valve | | 3251002 |
| Fitting G1/8" male/M5 female, with mesh filter | | 0101152 |
| Fitting G1/8" male/M5 female, with dual flow control valve | | 3251004 |
| Fitting 5xM5 female | | 0100260 |
| Fitting 5xM5 female, with dual flow control valve | | 3251005 |
| Fitting G1/8" male/M5 female, PA | | 3150196 |

For further information and dimensioned drawings, see *SUCTION CUPS FITTINGS* chapter.